

- I: Ti uguale nel passo e ridotte nelle biforcazioni (A= C>B)  
 II: Ti uguale nel passo e aumentate nelle biforcazioni (A= C<B)  
 III: Ti ridotte nel passo e nella biforcazione ( A>B y A>C; B= C ó B>C ó B<C)  
 IV: Ti ridotte nel passo e uguali nella biforcazione (A= B>C)  
 V: Ti ridotte nel passo e aumentate nella biforcazione (A>C ; B>A; B>C)



130R

(B1)

T RIDOTTA (A x B x C)

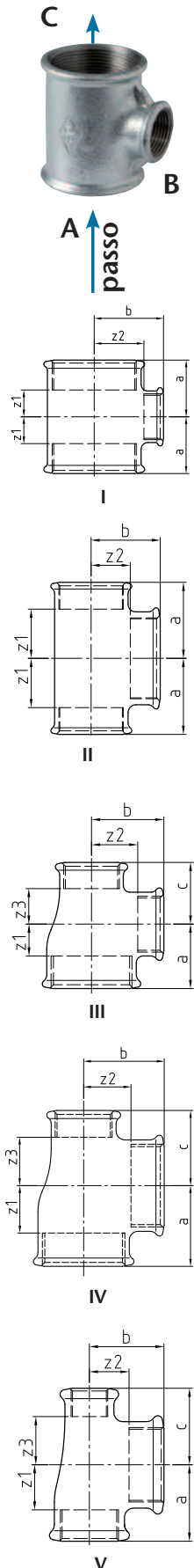

MISURA	TIPO	CODICE	DIMENSIONI (mm)						Peso (gr)
			a	b	c	z1	z2	z3	
3/8" - 1/4" - 3/8"	I	13001/5212	23	23	-	13	13	-	109
3/8" - 1/2" - 3/8"	II	13001/5232	26	26	-	16	13	-	80
3/8" - 3/4" - 3/8"	II	13001/5242	28	24	-	18	9	-	109
1/2" - 1/4" - 1/2"	I	13001/5313	24	24	-	11	14	-	82
1/2" - 3/8" - 3/8"	III	13001/5322	26	26	25	13	16	15	99
1/2" - 3/8" - 1/2"	I	13001/5323	26	26	-	13	16	-	106
1/2" - 1/2" - 3/8"	IV	13001/5332	28	28	26	15	15	16	108
1/2" - 3/4" - 3/8"	V	13001/5342	29	30	30	17	15	20	118
1/2" - 3/4" - 1/2"	II	13001/5343	31	30	-	18	15	-	159
1/2" - 1" - 1/2"	II	13001/5353	34	32	-	21	15	-	182
3/4" - 1/4" - 3/4"	I	13001/5414	26	27	-	11	17	-	130
3/4" - 3/8" - 1/2"	III	13001/5423	28	28	26	13	18	13	114
3/4" - 3/8" - 3/4"	I	13001/5424	28	28	-	13	18	-	139
3/4" - 1/2" - 3/8"	III	13001/5432	30	31	26	15	18	16	117
3/4" - 1/2" - 1/2"	III	13001/5433	30	31	28	15	18	15	122
3/4" - 1/2" - 3/4"	I	13001/5434	30	31	-	15	18	-	148
3/4" - 3/4" - 3/8"	IV	13001/5442	33	33	28	18	18	18	144
3/4" - 3/4" - 1/2"	IV	13001/5443	33	33	31	18	18	18	188
3/4" - 1" - 1/2"	V	13001/5453	36	35	34	21	18	21	201
3/4" - 1" - 3/4"	II	13001/5454	36	35	-	21	18	-	225
3/4" - 1 1/4" - 3/4"	II	13001/5464	41	36	-	26	17	-	251
1" - 1/4" - 1"	I	13001/5515	28	31	-	11	21	-	172
1" - 3/8" - 3/4"	III	13001/5524	30	32	28	13	22	13	181
1" - 3/8" - 1"	I	13001/5525	30	32	-	13	22	-	182
1" - 1/2" - 1/2"	III	13001/5533	32	34	28	15	21	15	221
1" - 1/2" - 3/4"	III	13001/5534	32	34	30	15	21	15	197
1" - 1/2" - 1"	I	13001/5535	32	34	-	15	21	-	196
1" - 3/4" - 1/2"	III	13001/5543	35	36	31	18	21	18	213
1" - 3/4" - 3/4"	III	13001/5544	35	36	33	18	21	18	184
1" - 3/4" - 1"	I	13001/5545	35	36	-	18	21	-	232
1" - 1" - 3/8"	IV	13001/5552	38	38	32	21	21	22	198
1" - 1" - 1/2"	IV	13001/5553	38	38	34	21	21	21	246
1" - 1" - 3/4"	IV	13001/5554	38	38	36	21	21	21	244
1" - 1 1/4" - 3/4"	V	13001/5564	42	40	41	25	21	26	316
1" - 1 1/4" - 1"	II	13001/5565	42	40	-	25	21	-	311
1" - 1 1/2" - 1"	II	13001/5575	46	42	-	29	23	-	338
1 1/4" - 3/8" - 1 1/4"	I	13001/5626	32	36	-	13	26	-	246
1 1/4" - 1/2" - 1"	III	13001/5635	34	38	32	15	25	15	240
1 1/4" - 1/2" - 1 1/4"	I	13001/5636	34	38	-	15	25	-	278
1 1/4" - 3/4" - 1/2"	III	13001/5643	36	39	36	17	24	23	236
1 1/4" - 3/4" - 3/4"	III	13001/5644	36	41	33	17	26	18	279
1 1/4" - 3/4" - 1"	III	13001/5645	36	41	35	17	26	18	287
1 1/4" - 3/4" - 1 1/4"	I	13001/5646	36	41	-	17	26	-	355
1 1/4" - 1" - 3/8"	III	13001/5652	41	43	30	22	26	20	258
1 1/4" - 1" - 1/2"	III	13001/5653	40	42	34	21	25	21	315
1 1/4" - 1" - 3/4"	III	13001/5654	40	42	36	21	25	21	300
1 1/4" - 1" - 1"	III	13001/5655	40	42	38	21	25	21	330
1 1/4" - 1" - 1 1/4"	I	13001/5656	40	42	-	21	25	-	405
1 1/4" - 1 1/4" - 1/2"	IV	13001/5663	45	45	38	26	26	25	322
1 1/4" - 1 1/4" - 3/4"	IV	13001/5664	45	45	41	26	26	26	380
1 1/4" - 1 1/4" - 1"	IV	13001/5665	45	45	42	26	26	25	371
1 1/4" - 1 1/2" - 1"	V	13001/5675	48	46	46	29	27	29	425
1 1/4" - 1 1/2" - 1 1/4"	II	13001/5676	48	46	-	29	27	-	440
1 1/4" - 2" - 1 1/4"	II	13001/5686	54	48	-	35	24	-	591
1 1/2" - 3/8" - 1 1/2"	I	13001/5727	35	40	-	16	30	-	339
1 1/2" - 1/2" - 1 1/4"	III	13001/5736	36	42	34	17	29	15	314
1 1/2" - 1/2" - 1 1/2"	I	13001/5737	36	42	-	17	29	-	362
1 1/2" - 3/4" - 1 1/4"	III	13001/5746	38	44	36	19	29	17	338
1 1/2" - 3/4" - 1 1/2"	I	13001/5747	38	44	-	19	29	-	419

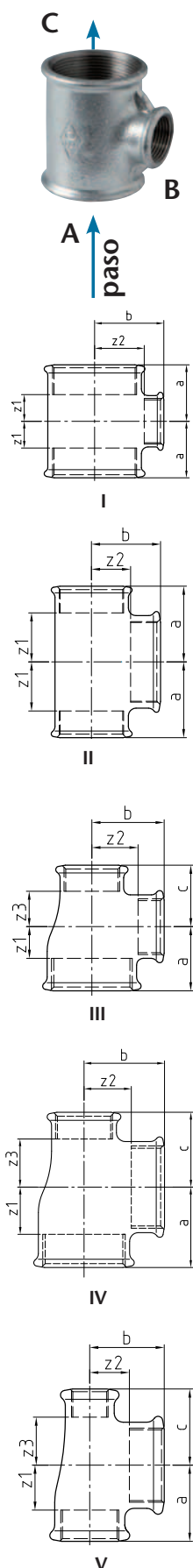
**130R**
**(B1)**
**T RIDOTTA (A x B x C)**

MISURA	TIPO	CODICE	DIMENSIONI (mm)						Peso (gr)
			a	b	c	z1	z2	z3	
1 1/2" - 1" - 1"	III	13001/5755	42	46	38	23	29	21	360
1 1/2" - 1" - 1 1/4"	III	13001/5756	42	46	40	23	29	21	390
1 1/2" - 1" - 1 1/2"	I	13001/5757	42	46	-	23	29	-	472
1 1/2" - 1 1/4" - 1"	III	13001/5765	46	48	42	27	29	25	454
1 1/2" - 1 1/4" - 1 1/4"	III	13001/5766	46	48	45	27	29	26	490
1 1/2" - 1 1/4" - 1 1/2"	I	13001/5767	46	48	-	27	29	-	514
1 1/2" - 1 1/2" - 1/2"	IV	13001/5773	50	50	42	31	31	29	524
1 1/2" - 1 1/2" - 3/4"	IV	13001/5774	50	50	44	31	31	29	504
1 1/2" - 1 1/2" - 1"	IV	13001/5775	50	50	46	31	31	29	457
1 1/2" - 1 1/2" - 1 1/4"	IV	13001/5776	50	50	48	31	31	29	525
1 1/2" - 2" - 1 1/4"	V	13001/5786	56	54	56	37	30	37	621
1 1/2" - 2" - 1 1/2"	II	13001/5787	55	52	-	36	28	-	617
2" - 1/2" - 1 1/2"	III	13001/5837	38	48	38	14	35	19	519
2" - 1/2" - 2"	I	13001/5838	38	48	-	14	35	-	480
2" - 3/4" - 1 1/2"	III	13001/5847	40	50	38	16	35	19	504
2" - 3/4" - 2"	I	13001/5848	40	50	-	16	35	-	592
2" - 1" - 1 1/2"	III	13001/5857	44	52	42	20	35	23	536
2" - 1" - 2"	I	13001/5858	44	52	-	20	35	-	583
2" - 1 1/4" - 1"	III	13001/5865	52	55	52	28	36	35	579
2" - 1 1/4" - 1 1/4"	III	13001/5866	48	54	45	24	35	26	572
2" - 1 1/4" - 1 1/2"	III	13001/5867	48	54	46	24	35	27	560
2" - 1 1/4" - 2"	I	13001/5868	48	54	-	24	35	-	733
2" - 1 1/2" - 1"	III	13001/5875	55	57	54	31	38	37	618
2" - 1 1/2" - 1 1/2"	III	13001/5877	52	55	50	28	36	31	580
2" - 1 1/2" - 2"	IV	13001/5878	52	55	-	28	36	-	809
2" - 2" - 1/2"	IV	13001/5883	58	58	48	34	34	35	666
2" - 2" - 3/4"	IV	13001/5884	58	58	50	34	34	35	748
2" - 2" - 1"	IV	13001/5885	58	58	52	34	34	35	766
2" - 2" - 1 1/4"	IV	13001/5886	58	58	54	34	34	35	824
2" - 2" - 1 1/2"	IV	13001/5887	58	58	55	34	34	36	749
2" - 2 1/2" - 2"	II	13001/5898	68	64	-	44	37	-	1189
2 1/2" - 1/2" - 2 1/2"	I	13001/5939	43	56	-	16	43	-	815
2 1/2" - 3/4" - 2 1/2"	I	13001/5949	45	58	-	18	43	-	770
2 1/2" - 1" - 2 1/2"	I	13001/5959	47	60	-	20	43	-	869
2 1/2" - 1 1/4" - 2 1/2"	I	13001/5969	52	62	-	25	43	-	951
2 1/2" - 1 1/2" - 2 1/2"	I	13001/5979	55	63	-	28	44	-	968
2 1/2" - 2" - 2"	III	13001/5988	67	72	62	40	48	38	1165
2 1/2" - 2" - 2 1/2"	I	13001/5989	61	66	-	34	42	-	1300
2 1/2" - 2 1/2" - 1 1/2"	IV	13001/5997	69	69	64	42	42	45	1500
2 1/2" - 2 1/2" - 2"	IV	13001/5998	73	73	68	46	46	34	1435
3" - 1/2" - 3"	I	13001/5A3A	46	63	-	15	50	-	1108
3" - 3/4" - 3"	I	13001/5A4A	48	66	-	18	51	-	1225
3" - 1" - 3"	I	13001/5A5A	51	67	-	21	50	-	1152
3" - 1 1/4" - 3"	I	13001/5A6A	55	70	-	25	51	-	1556
3" - 1 1/2" - 3"	I	13001/5A7A	58	71	-	28	52	-	1312
3" - 2" - 2"	III	13001/5A88	64	73	60	34	49	36	1480
3" - 2" - 3"	I	13001/5A8A	64	73	-	34	49	-	1687
3" - 2 1/2" - 3"	I	13001/5A9A	72	76	-	42	49	-	1738
3" - 3" - 2"	IV	13001/5AA8	78	79	72	48	49	48	1950
4" - 1/2" - 4"	I	13001/5C3C	60	76	-	24	63	-	1865
4" - 3/4" - 4"	I	13001/5C4C	62	78	-	26	64	-	1755
4" - 1" - 4"	I	13001/5C5C	56	81	-	20	64	-	1734
4" - 1 1/2" - 4"	I	13001/5C7C	64	84	-	28	65	-	2300
4" - 2" - 4"	I	13001/5C8C	70	86	-	34	62	-	2258
4" - 2 1/2" - 4"	I	13001/5C9C	77	89	-	41	62	-	2393
4" - 3" - 4"	I	13001/5CAC	84	92	-	48	62	-	2589
5" - 4" - 5"	I	13001/5DCD	100	110	-	60	72	-	4560

1/5 - 1= Nera - 5= Zincata